

# EST-44/66

## Quick Setup Instructions



**WARNING:** Electrical and plumbing connections need to be made by a licensed service person and comply with all Federal, State and Local Health, Electrical, Plumbing and Safety codes.

### STEP 1

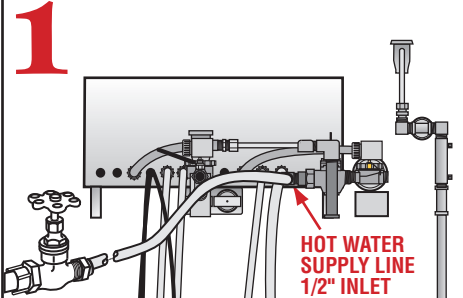

Connect Hot Water Supply Line to 1/2" Final Rinse Water Inlet. SEE STEP 11.

### STEP 2

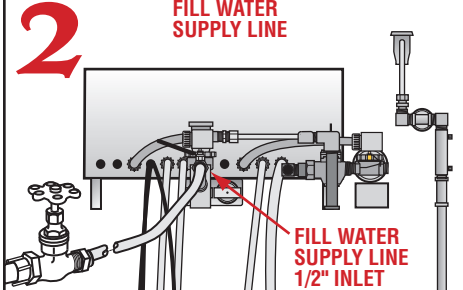

Connect Fill Water Supply Line (120F/140F) to a 1/2" water inlet to fill the machine.

### STEP 3

VOLTS	PHASE	AMPS	ELECTRICAL HARD WIRE CONNECTION POINT
208	1	76	
240	1	84	
208	3	50	
240	3	54	
HEATER 10kW			

**3 Phase:** Connect the wire with the highest voltage (stinger lead) to L2 on the contactor. L1, L2 and L3 must comply with all local and state electrical codes for sizing of wire and circuit breaker protection. Additional information can be found in the Installation and Operation manual supplied with machine.

- 1 1/2" FINAL RINSE WATER INLET
- 2 1/2" FILL WATER INLET
- 3 ELECTRICAL CONNECTION
- 4 SCRAP TRAP DRAIN

EST44  
REAR VIEW

OPTIONAL VENT  
HOODS 4"X16"

MIXING  
CHAMBER

5

DRAIN PLUMBING  
NOT SUPPLIED

4 DRAIN PIPE

5 DETERGENT  
FITTING INLET

2" HOLE  
PLUG

### STEP 4

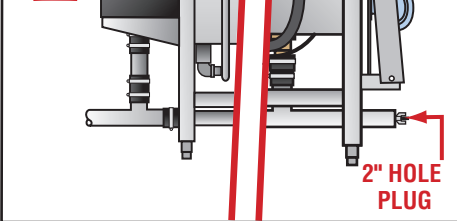

Connect drain at either end of the horizontal drain pipe from wash tank or scrap trap drain.

### STEP 5

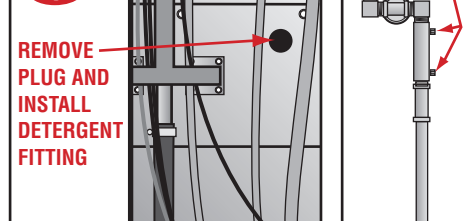

Remove plug to install detergent fitting. Remove plugs from the mixing chamber to install sani/rinse injection fitting (sanitizer, detergent and rinse injection fittings provided by dispenser manufacturer, CMA does not supply.)

# EST-44/66

## Quick Setup Instructions

**WARNING** Electrical and plumbing connections need to be made by a licensed service person and comply with all Federal, State and Local Health, Electrical, Plumbing and Safety codes.



- 11** \* PRESSURE REGULATOR
- 11** PRESSURE GAUGE
- DOOR SAFETY SWITCH
- 8** RINSE THERMOSTAT
- 7** MOTOR CAP

\*PRESSURE REGULATOR LOCATED BEHIND CONTROL BOX

EST44 FRONT VIEW



- e-TEMP** **11**
- MANUAL AUTO SWITCH** **11**
- POWER ON/OFF** **10**
- TEMPERATURE GAUGES**
- DETERGENT PROBE INLET** **6**
- WASH THERMOSTAT** **8**
- STAINLESS STEEL SCRAP TRAP**

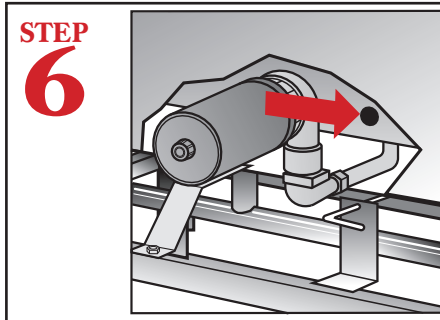
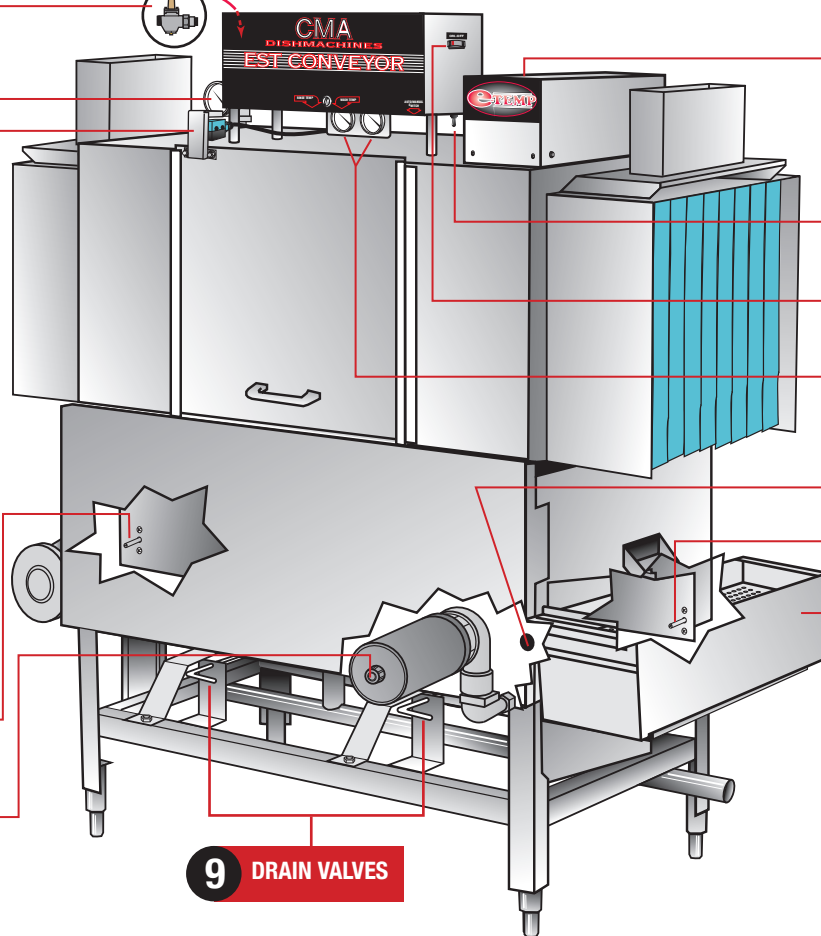

Remove the stainless steel plug to install the detergent probe (provided by dispenser manufacturer, CMA does not supply).

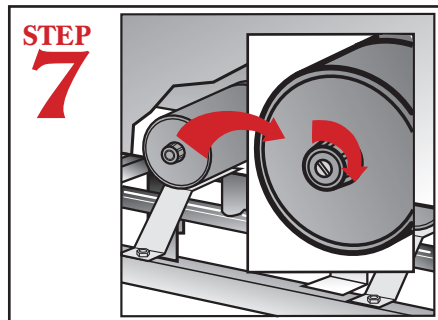

Remove motor cap to verify motor rotation. Shaft slot should be rotating clock-wise when motor is running. If shaft slot is turning counter clock wise, swap L-1 and L-3 on main contactor.

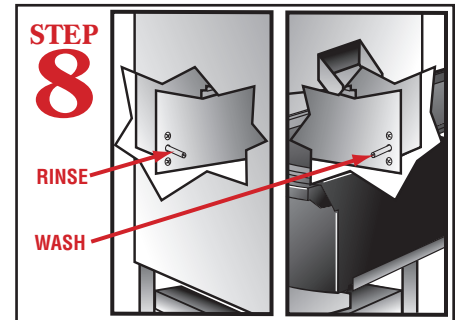

Adjust thermostat if necessary. Water temperature should be 140F rinse and 140F wash for EST44L. The EST44H should read 180F rinse 155F wash.

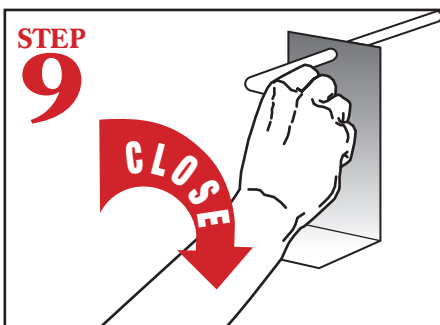

Close drain valve before filling machine with water.

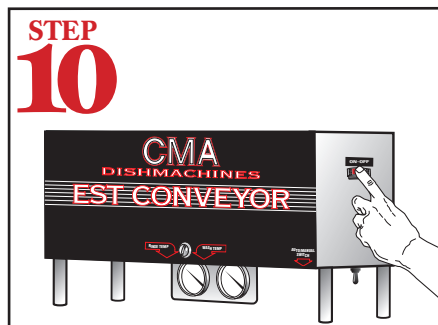

Turn on dishmachine by pressing the "POWER ON/OFF" switch to the "ON" position. Dishmachine will fill automatically and will also activate heater.

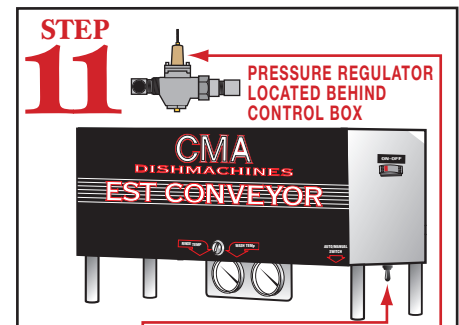

Switch Manual/Auto switch to Manual Mode. Adjust Pressure Regulator Valve to 20 PSI. **If E-Temp is installed on machine, press rinse switch to fill E-Temp tank. Return Manual/Auto switch to Auto Mode.**

an Ali Group Company



11-2016