



PCB-631

DATE OF BULLETIN:

4-7-2015

THIS BULLETIN SUPERSEDED BULLETIN(S):

None

MODELS AFFECTED:

GTX Machines

MACHINE SYMPTOMS:

NA

SCOPE OF BULLETIN:

To inform about the new standard Two-Tank parts that begins on April 15th, 2015.

Serial Break Point for Two-Tank parts: #83479

If Tank-in-Tank (*Old Style*) is still requested, this can be added with the Option Number: # 250-203

MATERIALS REQUIRED:

To update old machines to these specifications use the part numbers listed below.

Tomcat GTX: Part # 600-6000CK - Complete 2 Tank Assembly

REVISIONS:

Tomcat GTX Riders now come standard with a Two-Tank Solution/Recovery System.

Two-Tank design permits:

- Thicker Recovery Tank Wall & additional Recovery Tank capacity for avoiding water/foam into vac motors. With specific design requirements for the previous Tank-in-Tank molds, achieving equal tank capacities was all that could be accomplished.
- New drain saver basket is bright yellow and visible from the outside of the machine through clear access cover. This should encourage more awareness of when to empty. It is also designed so when full, it will spill over to the tank instead of allowing the Recovery Hose to back-fill causing damage if not addressed.
- Larger Vacuum Screen and easier access. Better seal between gasket and ball, keeping more moisture from the vacuum motors.
- Front Site Tube
- Retro Fits to old machines.
- Better Solution Fill points (2 of them). One includes a filter screen for bucket use.
- Cup Holder

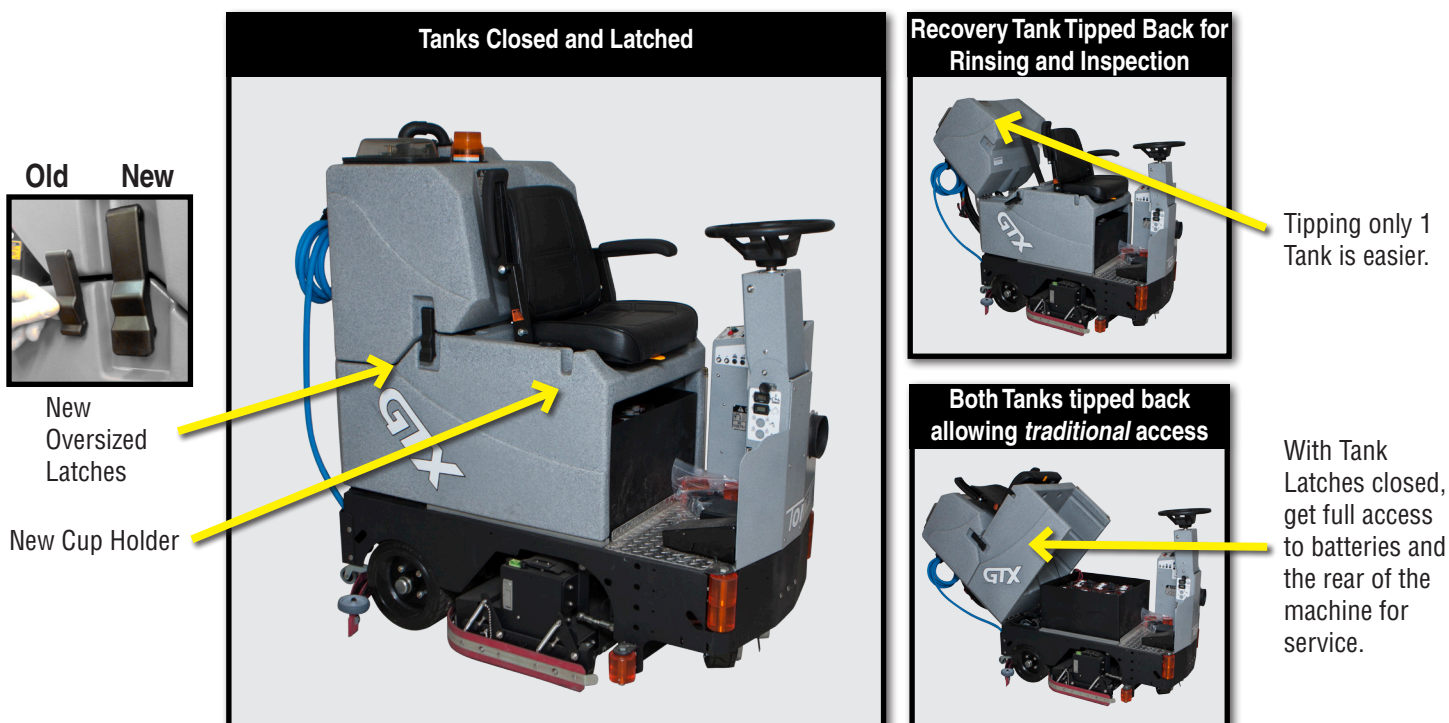

Two Solution Fill Points:



Improved Vac Screen Access:

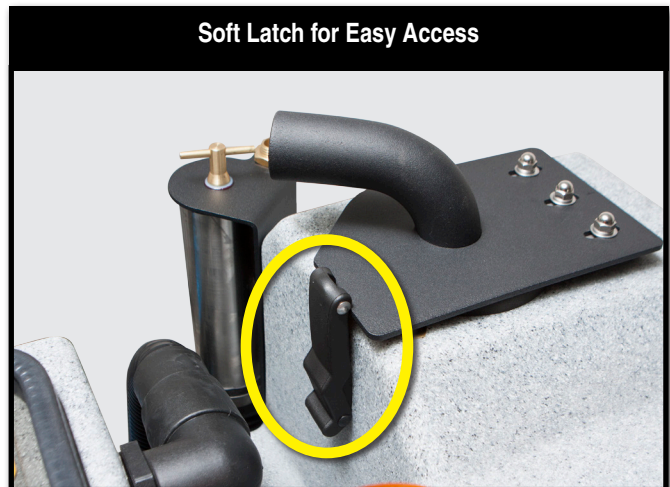

Improved Drain Saver:



Easily Visible through Clear Access



Larger Capacity and Overflow Ability
eliminates the Squeegee Hose clogging
potential.