

**Subject:** Power Cord Bracket  
**Product(s):** SC750  
SC800  
**System:** On-Board Charging  
**Number:** TSB-FC-2013-112  
**Date:** 12 July 2013  
**ODM/ECO:** None  
**Urgency:** Level 3

**SYMPTOM:**

High heat may be observed at the charger to extension cord plug interface

**ISSUE:**

High resistance at the charger to cord interface

**WARNING:** ALWAYS USE THE WALL PLUG TO CONNECT AND DISCONNECT POWER TO THE CHARGER (FIG A)

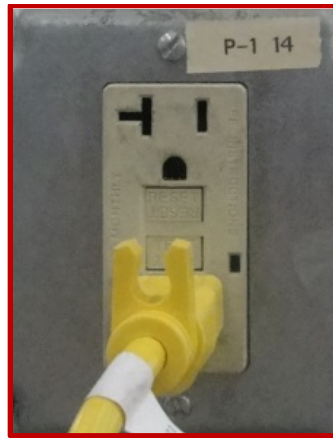

FIG A

PROPERTY DAMAGE OR PERSONAL INJURY MAY RESULT IF THE OPERATOR OF THE MACHINE USES THE CHARGER TO EXTENSION CORD CONNECTION POINT AS A LOCATION TO CONNECT AND DISCONNECT THE ONBOARD CHARGER POWER. (FIG B) INSPECT THE CORD FOR SIGNS OF DAMAGE (IE PITTING, DISCOLORATION, DEGRADATION) AS SHOWN IN FIG C INDICATED BY THE RED ARROW BELOW.

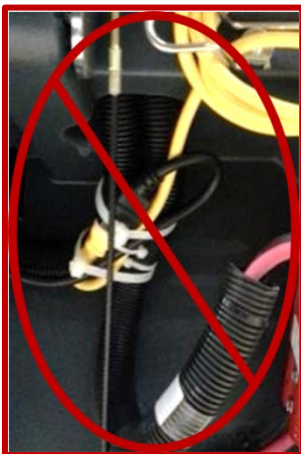

FIG B

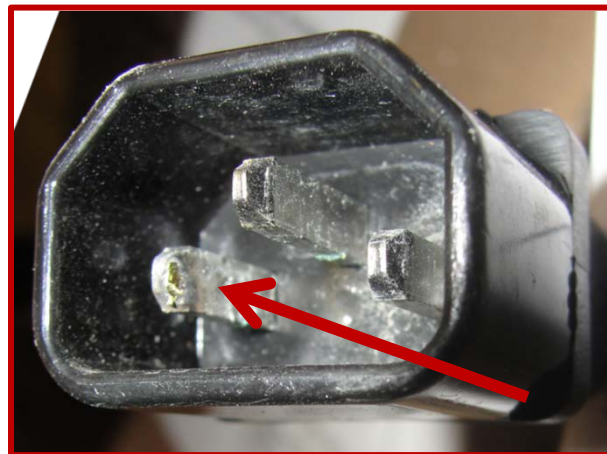

FIG C

**Technical Service Bulletin Levels**

Level 1: General Information  
Level 2: Continuous Quality Improvement  
Level 3: Mandatory Update

**Subject:** Power Cord Bracket  
**Product(s):** SC750  
SC800  
**System:** On-Board Charging  
**Number:** TSB-FC-2013-112  
**Date:** 12 July 2013  
**ODM/ECO:** None  
**Urgency:** Level 3

**CAUSE:**

- 1) Water ingress or contamination at the charger and extension cord interconnect plug
- 2) Using the charger and extension cord interconnect point as the primary disconnect point when plugging in and unplugging the charger during normal use

**PARTS LIST NUMBER(S) AFFECTED:**

56042535, 56042542

**PRODUCTION CORRECTIVE ACTIONS:**

- Improved orientation of the plug assembly
- A new method for securing the connection point by installing bolt down P clamps on both sides of interconnect cord
- Improved cord with increased heat resistance

**SOLUTION IMPLEMENTATION DATE and/or SERIAL NUMBER:**

- Implementation Shipping Date: 20 MAY, 2013
- Serial Number: 4000058496
- Reference Instruction Sheet: 56090165

**SPECIAL TOOLS REQUIRED:**

- None

**PARTS REQUIRED:**

- 56383384 (Americas)
- 56383394 (EMEA/APAC)

**FIELD CORRECTIVE ACTIONS:**

- Install appropriate bracket kit per instruction sheet 56090165 on all machines ***equipped with on-board chargers*** having serial numbers prior to 400058496

**Technical Service Bulletin Levels**

Level 1: General Information  
Level 2: Continuous Quality Improvement  
Level 3: Mandatory Update



**Nilfisk  
Advance**  
*setting standards*

## TECHNICAL SERVICE BULLETIN

**Subject:** Power Cord Bracket  
**Product(s):** SC750  
SC800  
**System:** On-Board Charging  
**Number:** TSB-FC-2013-112  
**Date:** 12 July 2013  
**ODM/ECO:** None  
**Urgency:** Level 3

### 56383384 POWER CORD BRACKET KIT

SC750, SC800, SC750 ST, SC800 ST Models: ALL Domestic

### 56383394 POWER CORD BRACKET KIT

SC800 Models: ALL European

#### CONTENTS OF KIT

Item	Ref. No.	Qty	Description
[ ]	56090165	1	Instruction Sheet
1	56009062	2	Scr, Pan Phil Thd Form 1/4-20 X .50
2	56323260	4	Clamp, Hose Support
3	56383393	1	Power Cord Bracket
4	56478523	2	Tie, Cable
5	56383385	1	Cord Charge Yellow US (56383384)
[5]	56383388	1	Cord Charger Europe (56383394)
[5]	56383389	1	Cord Charger UK (56383394)
6	56383391	1	Plug IEC 60320 Sheet E

[ ] = Not Shown

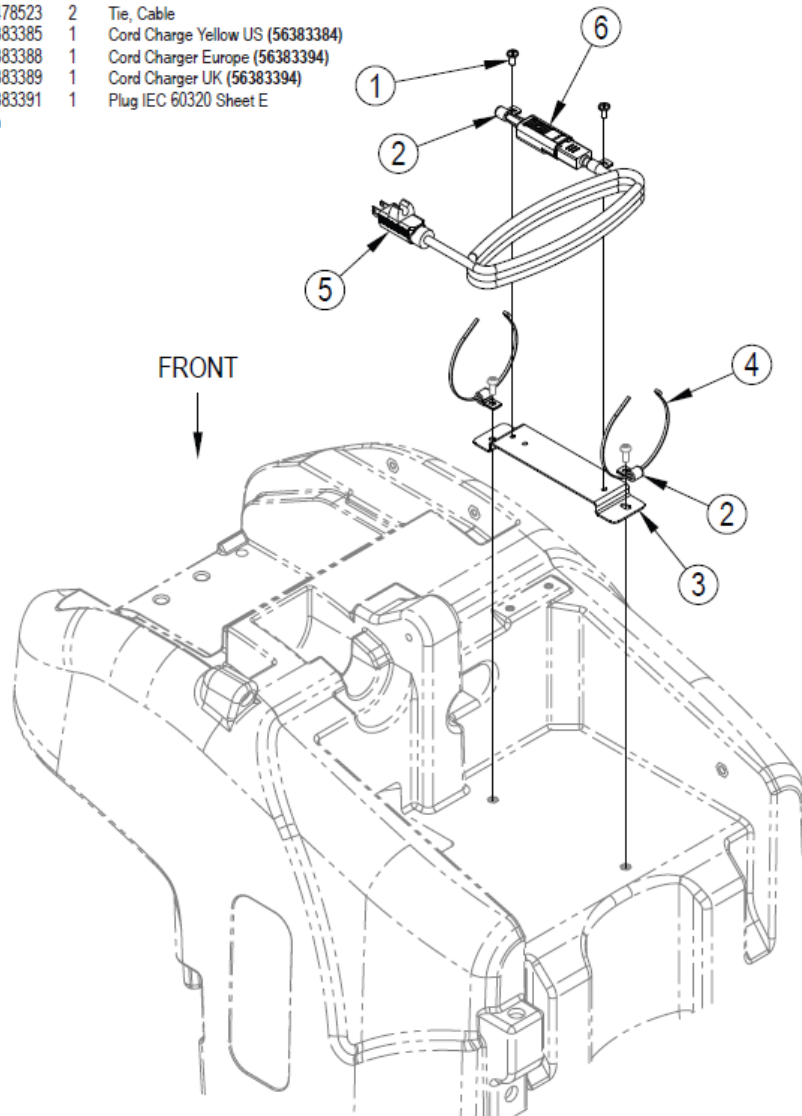

#### Technical Service Bulletin Levels

Level 1: General Information

Level 2: Continuous Quality Improvement

Level 3: Mandatory Update



**Nilfisk  
Advance**  
*setting standards*

## TECHNICAL SERVICE BULLETIN

**Subject:** Power Cord Bracket  
**Product(s):** SC750  
SC800  
**System:** On-Board Charging  
**Number:** TSB-FC-2013-112  
**Date:** 12 July 2013  
**ODM/ECO:** None  
**Urgency:** Level 3

### INSTALLATION INSTRUCTIONS

#### **WARNING!**

DISCONNECT BATTERIES BEFORE SERVICING.

#### REMOVE MOUNTING TABS AND CABLE TIES

- 1 SEE FIGURE 1. Cut Cable Ties (A & B).
- 2 Remove Screws (C) and save for reuse.
- 3 Discard Mounting Tabs (D).
- 4 Cut the plug off the end of the battery charger cord attached to the battery charger.
- 5 Discard the old power cord that plugged into the battery charger.

FIGURE 1

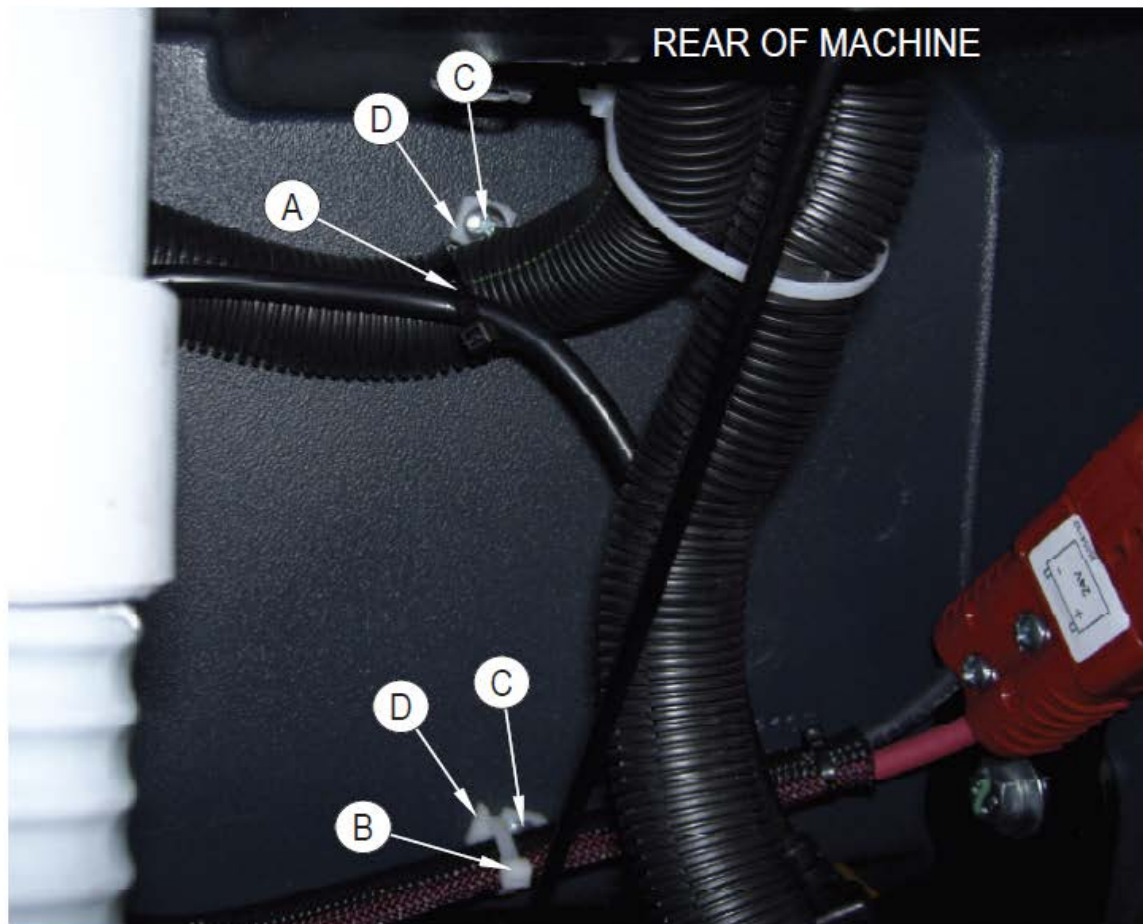

#### Technical Service Bulletin Levels

Level 1: General Information

Level 2: Continuous Quality Improvement

Level 3: Mandatory Update



**Nilfisk  
Advance**  
*setting standards*

## TECHNICAL SERVICE BULLETIN

**Subject:** Power Cord Bracket  
**Product(s):** SC750  
SC800  
**System:** On-Board Charging  
**Number:** TSB-FC-2013-112  
**Date:** 12 July 2013  
**ODM/ECO:** None  
**Urgency:** Level 3

### INSTALL NEW CHARGER CORD PLUG

- 6 SEE FIGURE 2. Strip the end of the Charger Cord (E) as shown.
- 7 Disassemble Plug (6) and install on Charger Cord (E) as shown.

FIGURE 2

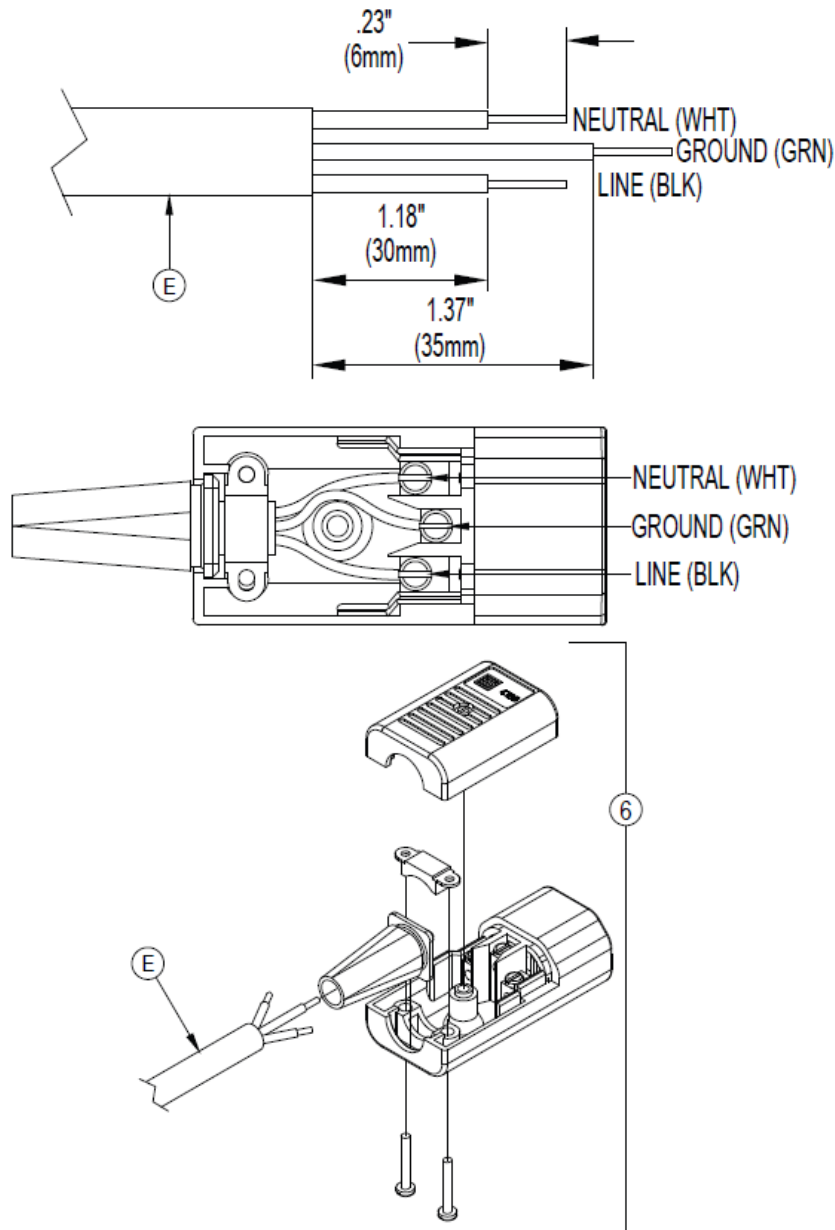

#### Technical Service Bulletin Levels

- Level 1: General Information
- Level 2: Continuous Quality Improvement
- Level 3: Mandatory Update





**Nilfisk  
Advance**  
*setting standards*

## TECHNICAL SERVICE BULLETIN

**Subject:** Power Cord Bracket  
**Product(s):** SC750  
SC800  
**System:** On-Board Charging  
**Number:** TSB-FC-2013-112  
**Date:** 12 July 2013  
**ODM/ECO:** None  
**Urgency:** Level 3

### INSTALL POWER CORD BRACKET AND POWER CORDS

- 8 SEE FIGURE 3. Install Power Cord Bracket (3) as shown using Screws (C) removed in FIGURE 1 and Hose Support Clamps (2). **NOTE:** Bracket (3) mounts to the same holes as the Mounting Tabs (D) removed in FIGURE 1
- 9 Mount Charge Cord (E) to Bracket (3) as shown using Screw (1) and Hose Support Clamp (2).
- 10 Plug Charge Cord (5) into Plug (6) and then secure to Bracket (3) using the remaining Hose Support Clamp (2) and Screw (1). **NOTE:** Kit 56383394 includes two Cords (5). Use the appropriate cord depending on your needs.
- 11 Use the two Cable Ties (4) to replace the Cable Ties (A & B) cut off in FIGURE 1.
- 12 Reconnect the batteries and wrap Cord (5) around the cord wrap on the rear of the machine.

FIGURE 3

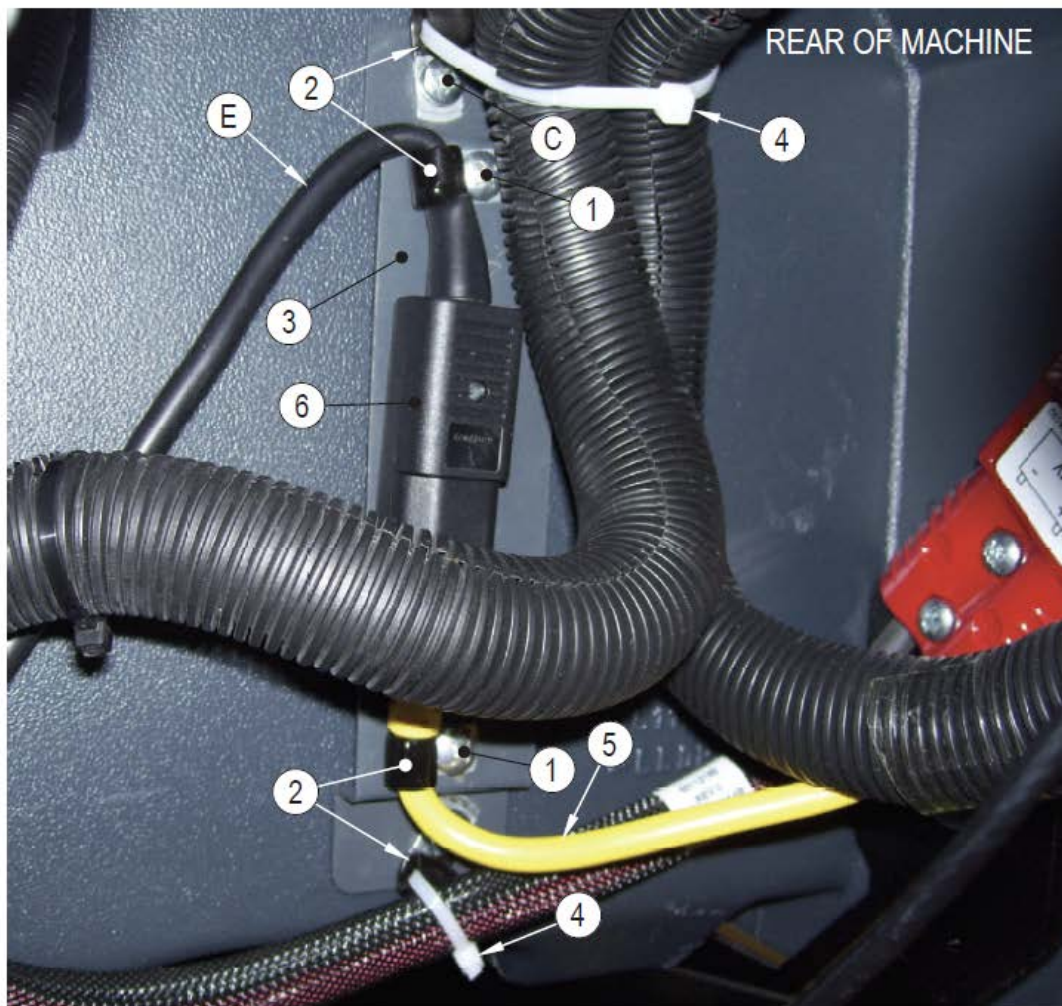

#### Technical Service Bulletin Levels

- Level 1: General Information
- Level 2: Continuous Quality Improvement
- Level 3: Mandatory Update



**Nilfisk  
Advance**  
*setting standards*

## TECHNICAL SERVICE BULLETIN

**Subject:** Power Cord Bracket  
**Product(s):** SC750  
SC800  
**System:** On-Board Charging  
**Number:** TSB-FC-2013-112  
**Date:** 12 July 2013  
**ODM/ECO:** None  
**Urgency:** Level 3

### COMPONENT LOCATION(S):



Machine (side)



Serial Number Tag



Serial Number Tag



Machine (rear) and power cord bracket

### Technical Service Bulletin Levels

Level 1: General Information

Level 2: Continuous Quality Improvement

Level 3: Mandatory Update